

IN WALL FILL/SPILL CONTAINER - FLUSH TYPE

FEATURES:

- NEMA 4X - ENCLOSURE: WELDED 12 GA. 304 STAINLESS STEEL
- CAPACITY: 5 GALLONS
- FLEXIBLE ENTRY BOOT FOR EASE OF INSTALLATION
- 3 POINT LATCH STAINLESS HANDLE WITH KEYED LOCKING PROVISION
- OPTIONAL OVERFILL ALARM
- OPTIONAL LEAK SWITCH
- OPTIONAL CAUTION SIGN

SIDE VIEW/SECTION A-A

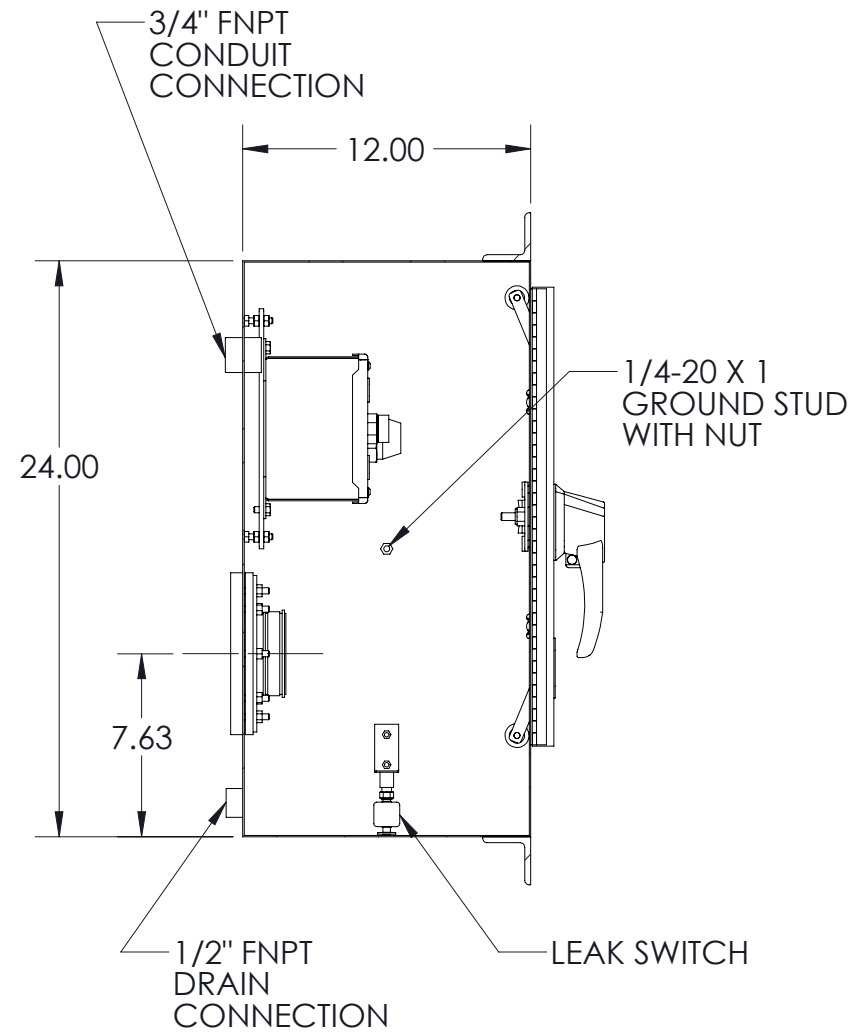

FRONT VIEW

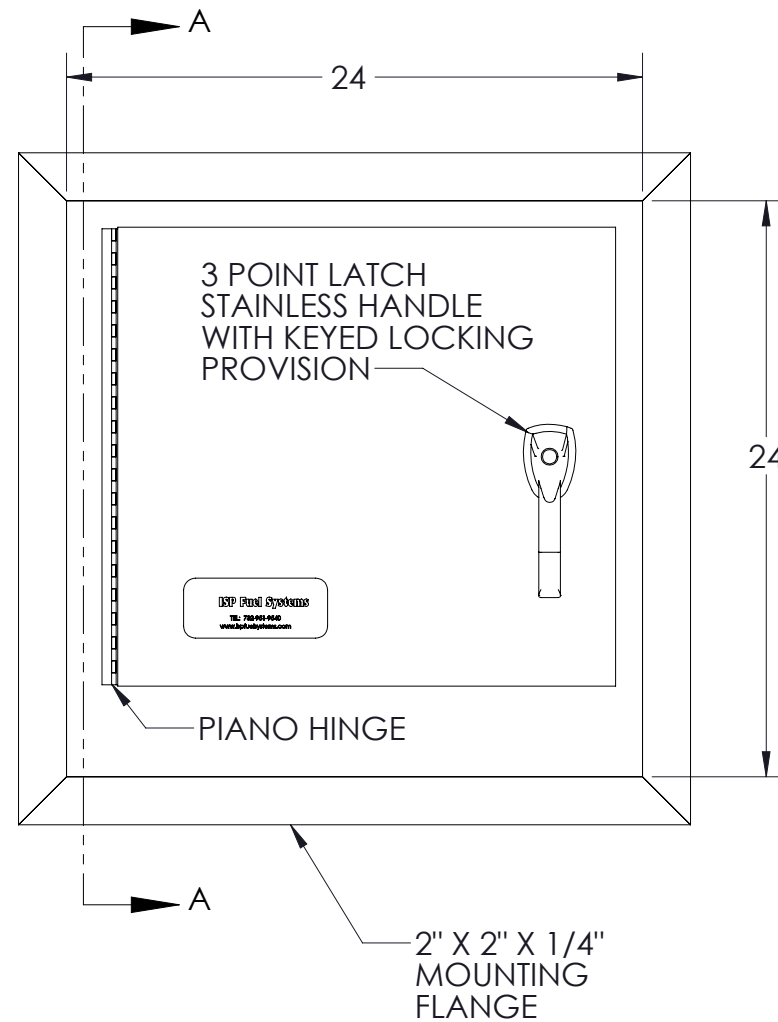

FRONT VIEW - DOOR OPEN

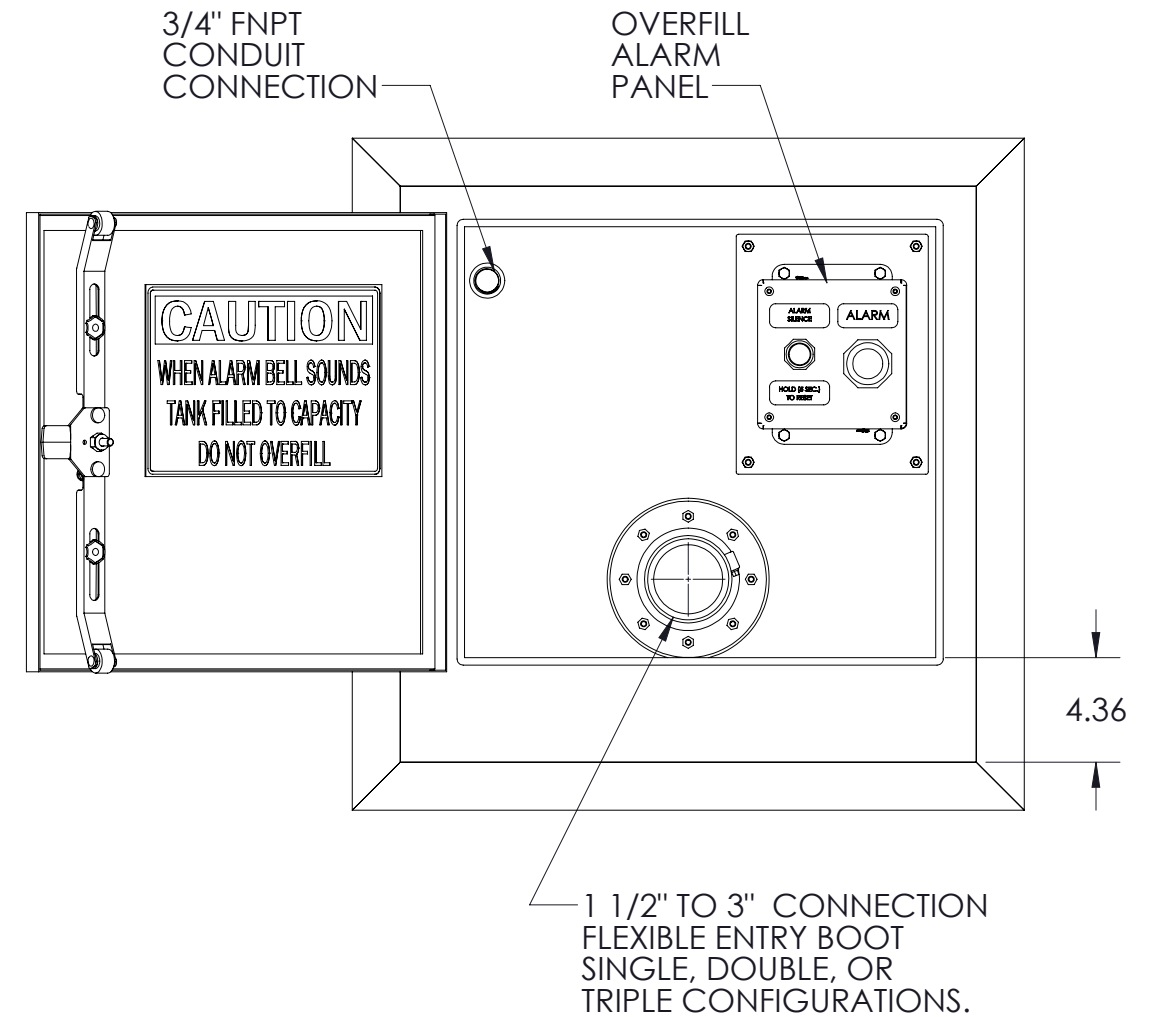

**ISP Fuel Systems**

9 CHRIS COURT, SUITE F  
DAYTON, NJ 08810  
VOICE#: 732-951-9540  
[www.ispfuelsystems.com](http://www.ispfuelsystems.com)

PROJECT:

DESCRIPTION: FILL PORT, GENERAL ASSEMBLY DRAWING

|          |            |      |         |
|----------|------------|------|---------|
| DRAWN    | G. HENSHAW | DATE | 2.28.22 |
| CHECKED  |            | DATE |         |
| APPROVED |            | DATE |         |

THIS DOCUMENT CONTAINS CONFIDENTIAL OR PROPRIETARY INFORMATION OF ISP FUEL SYSTEMS. NEITHER THE DOCUMENT NOR THE INFORMATION THEREIN IS TO BE REPRODUCED, DISTRIBUTED, USED OR DISCLOSED, EITHER IN WHOLE OR IN PART, EXCEPT AS SPECIFICALLY AUTHORIZED BY ISP FUEL SYSTEMS.

| REV. | DATE | BY | COMMENTS |
|------|------|----|----------|
|      |      |    |          |

STATUS:

**SUBMITTAL DRAWING**

SCALE: NONE  
DRAWING NO. WMFB-FLUSH

FILE NO. NA

PAGE #: 1 OF 1